

5. CLEARANCE REDUCTION

CLEARANCE REDUCTION WITH OPTIONAL SHIELDING MATERIALS

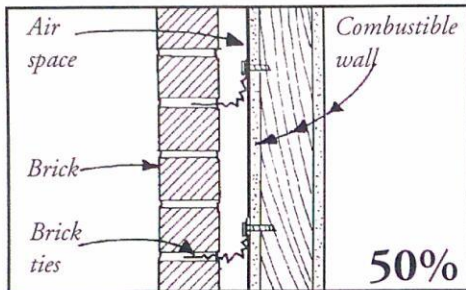

Brick shields without steel backing (above) give only a 50% reduction in clearance. Shields constructed of tile on non-combustible board (below) also give a 50% clearance reduction.

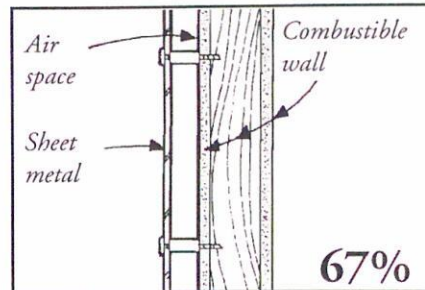
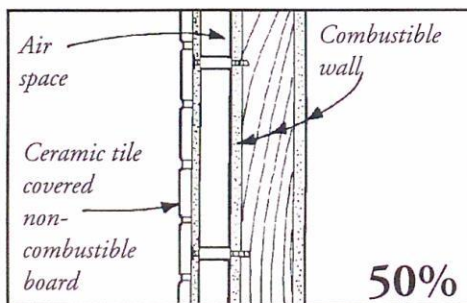

Sheet metal shields or those backed with sheet metal give greater reductions in clearance because of their ability to conduct heat rapidly across their surface, reducing the intensity of hot spots.

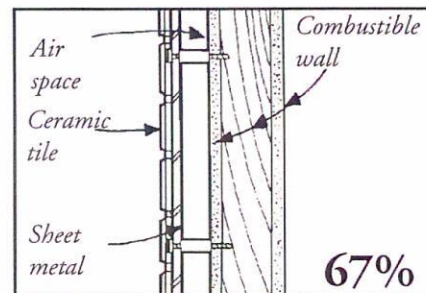

Sheet metal shields with 21 mm (7/8") air space behind give a 67% reduction in the minimum clearance. Brick or tile shields backed with sheet metal also give a 67% reduction in clearance.

